

PRODUCT NUMBER  
SEE SHEET 4

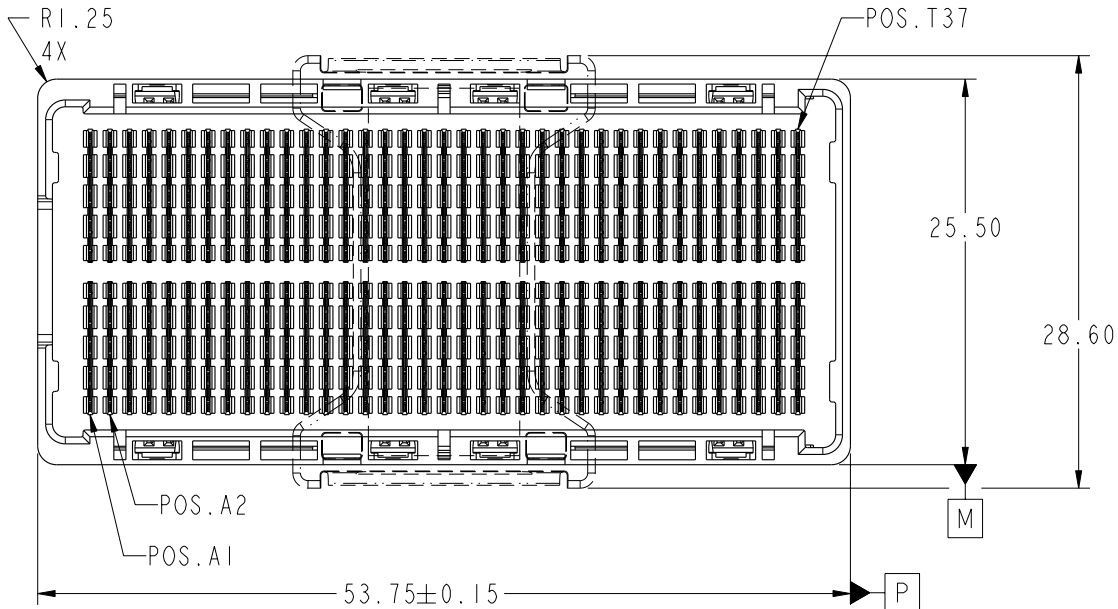

OPTIONAL PICK-UP CAP

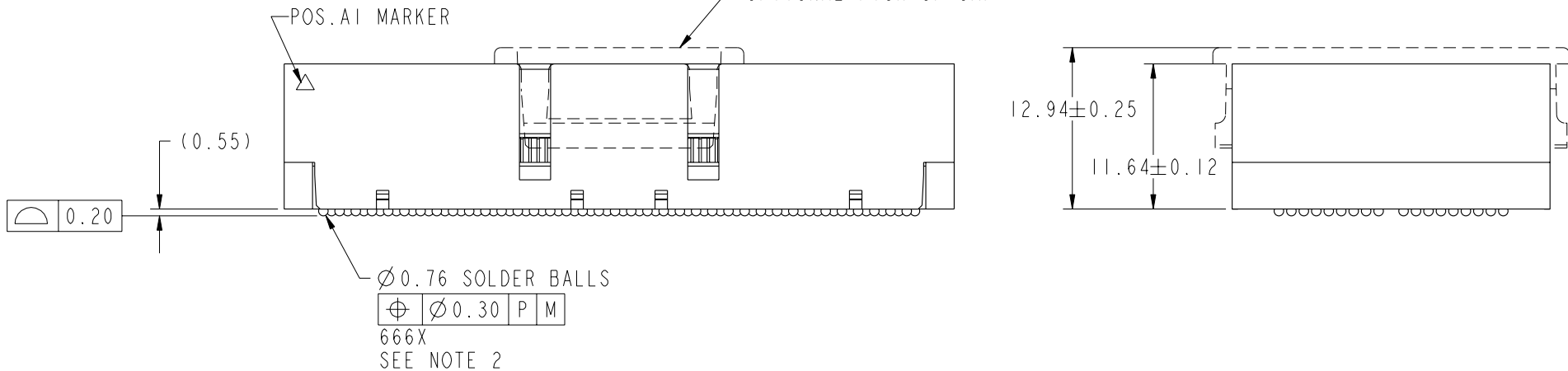

www.fciconnect.com			surface 3.2 ASME Y14.5	tolerance std -	projection ASME	mm
TOLERANCES UNLESS OTHERWISE SPECIFIED			ANGULAR	LINEAR	size A4	Scale 1:1
Dr	T. BRUNGARD	2006-12-12	0.X	±	ECN	V08-0198
Eng	D. HARPER	2006-12-12	0.XX	±	Product family	GIG-Array
Chr	D. HARPER	2006-12-12	0.XXX	±R	Spec ref	-
Appr	D. HARPER	2006-12-12	Product family GIG-Array		Spec ref -	
FCI			GIG-Array, PLUG ASSEMBLY		dwg no	10026804
			12mm, 296 SIGNAL POSITION		Rev.	C
			catalog no	-	CUSTOMER	sheet 1 of 4

	rev	ecn no	dr	date
	A	V06-1178	LP	2006-12-12
	B	V07-0440	LP	2007-07-05
	C	V08-0198	LP	2008-04-28

TOLERANCES UNLESS OTHERWISE SPECIFIED			
LINEAR	0.X	±.3	-
	0.XX	±.10	-
	0.XXX	±.050	-
ANGULAR	0°	±2°	-

PRODUCT NUMBER  
SEE SHEET 4

KEY ORIENTATION SILKSCREEN  
(OPTIONAL)

④ CONTACTS IN  
ROWS J & K ARE  
TIED TOGETHER  
(COMMONED)

SEE NOTES 4 & 5

T  
R  
P  
M  
K  
J  
G  
E  
C  
A

S  
Q  
N  
L  
H  
F  
D  
B

0.65  
73X

1.30  
36X

23.725

47.45

(53.75)

∅ 0.60  
0.55

∅ 0.10 N  
PAD SIZE  
666X  
SEE NOTE 6

(R1.25)  
4X

2.00

18.00

9.00

(25.50)

1.00  
8X (2 PLACES)

STENCIL CONNECTOR OUTLINE  
ONTO BOARD.

**BOARD PATTERN**

N



title GIG-Array, PLUG ASSEMBLY  
12mm, 296 SIGNAL POSITION  
catalog no -

dwg no 10026804

Rev. C

CUSTOMER sheet 2 of 4



PRODUCT NUMBER  
SEE SHEET 4

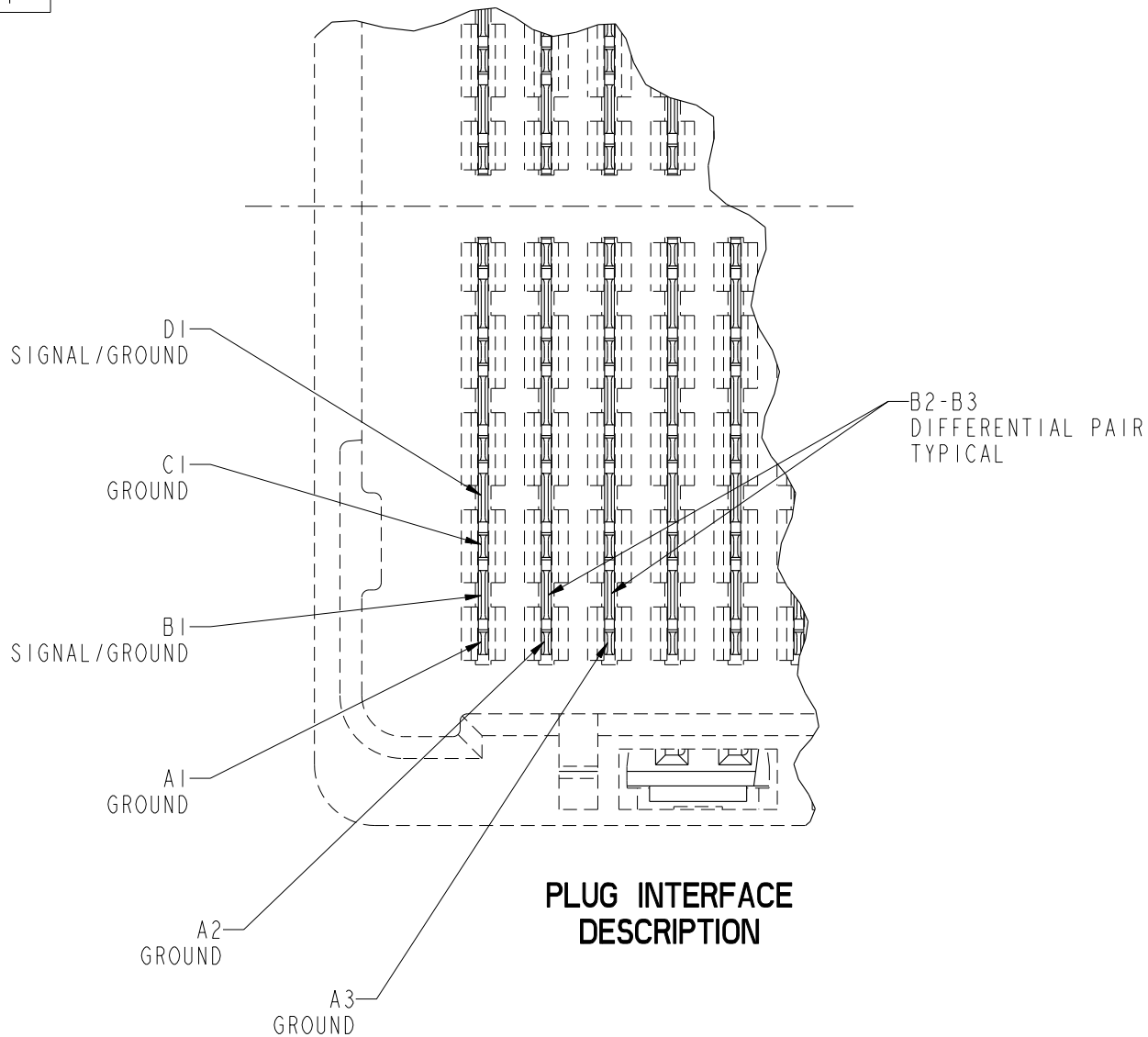

**PLUG INTERFACE  
DESCRIPTION**



Copyright FCI.

	title GIG-Array, PLUG ASSEMBLY 12mm, 296 SIGNAL POSITION	dwg no 10026804	Rev. C
	catalog no -	CUSTOMER	sheet 3 of 4

REV F - 2006-04-17

PRODUCT NUMBER	SOLDER BALL
10026804-001	SnPb
10026804-001LF	SnAgCu LEADFREE (7)(8)

**FLAT AREA PICK-UP CAP**

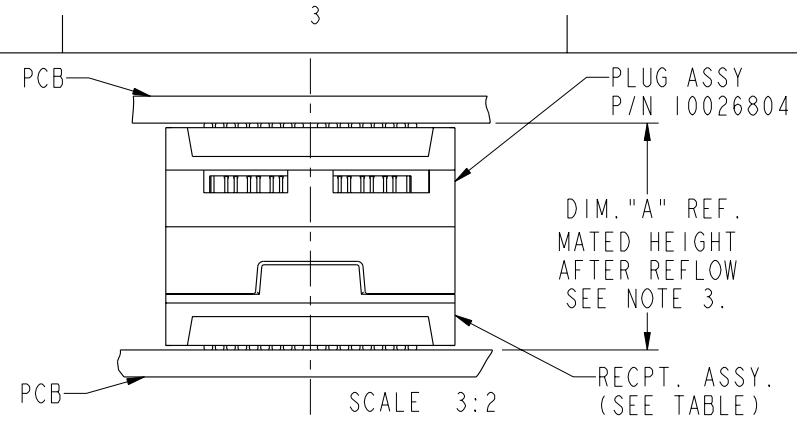
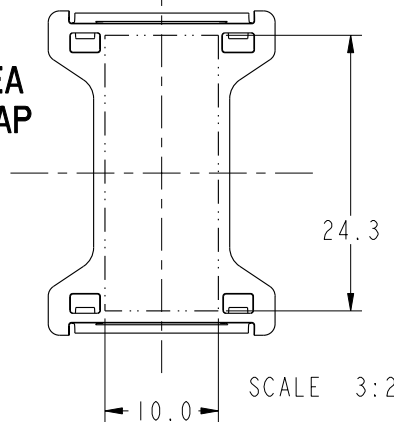

**END VIEW OF MATED CONNECTORS**

DIM. "A"	RECPT. ASSY. P/N
17	55701
22	10032376
27	55733

**NOTES:**

- ① MAT'L:  
HOUSING: LCP  
CONTACT: COPPER ALLOY  
PLATING (CONTACT): Au OVER Ni.  
UL RATING: 94 V-0
- ② SOLDER BALLS WILL NOT BE PERFECT SPHERICAL SHAPE DUE TO REFLOW ATTACHMENT.
- ③ MATED HEIGHT EFFECTED BY CUSTOMERS' PCB PAD SIZE, PLATING, SOLDER REFLOW PROFILE & SOLDER PASTE.
- ④ CONTACTS IN ROWS A,C,E,G,J,K,M,P,R AND T ARE SINGLE BEAM CONTACTS, TYPICALLY USED AS GROUND PINS. (NOTE: CONTACTS IN ROWS J & K ARE TIED TOGETHER [COMMONED])
- ⑤ CONTACTS IN ROWS B,D,F,H,L,N,Q AND S ARE DUAL BEAM CONTACTS, TYPICALLY USED AS SIGNAL PINS.

NOTES CONTINUED

- ⑥ SPECIFIED POSITIONAL TOLERANCE DEFINES PAD TO PAD LOCATION WITHIN LAND PATTERN. POSITIONAL TOLERANCE OF LAND PATTERN TO FUDICIAL MARKS OR PCB DATUMS SHALL BE DEFINED BY CUSTOMER. FOR RECOMMENDED PRODUCT APPLICATION AND PCB DESIGN DETAILS, SEE DOC. NO. GS-20-016.
- ⑦ FOR PROPER APPLICATION FOLLOW FCI APPLICATION SPECIFICATION GS-20-033 LEADFREE SOLDER BALLS WILL NOT SOLDER PROPERLY IN A LEADED SOLDER PROCESS DUE TO A HIGHER REFLOW TEMPERATURE, LEADFREE PRODUCT IS THEREFORE NOT BACKWARDS COMPATIBLE WITH LEADED OR SOME SOLDERING APPLICATIONS. REFERENCE FCI APPLICATION SPECIFICATION.
- ⑧ THIS PRODUCT MEETS THE EUROPEAN UNION DIRECTIVES AND OTHER COUNTRY REGULATIONS AS DESCRIBED IN GS-22-008. PRODUCT MEETING WITH THES DIRECTIVE IS IDENTIFIED IN THE LOT CODE NUMBER MARKED ON EACH PART BY HAVING AN "X" IN THE SEVENTH CHARACTER POSITION.



Copyright FCI.



GIG-Array, PLUG ASSEMBLY 12mm, 296 SIGNAL POSITION catalog no	dwg no 10026804	Rev. C
	CUSTOMER	sheet 4 of 4